

TERMINAL REMOVAL TOOL INSTRUCTIONS

Part No. 200155K

Connector Replacement Instructions

Two wire connector shown as an example. Other connectors are similar.

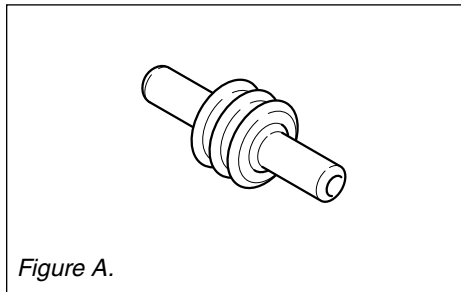

Figure A.

STEP 1. Using a small flat head screwdriver, disconnect the TPA (terminal protection assurance) from BOTH the new and existing connector bodies, then remove the two red rubber plugs (if present) (Fig. A) from the new connector (Fig. B, item 2).

STEP 2. Insert terminal removal tool (Fig. B, item 3) into both terminal recesses of the existing connector body as shown in Fig. B, then pull out the two wires. Take note of which wire was inserted in terminal 'A' and terminal 'B' (see Fig. B inset) as these will have to line up the same way on the new connector (Fig. B, item 2).

STEP 3. Using a small screwdriver, carefully lift up the tab on the back of both terminals so that they sit proud as shown in Fig. B.

STEP 4. Ensure both wires are lined up with the correct 'A' & 'B' terminal on the new connector as noted above and shown in Fig. B inset.

STEP 5. Push both wires into the new connector (item 2) until they click into place. Pull back on both wires firmly to ensure they are fully seated in the connector body. If seated correctly, the wires should not pull out. **NOTE:** If only one wire is used, ensure a red rubber plug (see Fig. A) is inserted into the unused terminal.

STEP 6. Replace the TPA over the new connector body, ensuring it clicks into place. Discard old connector body.

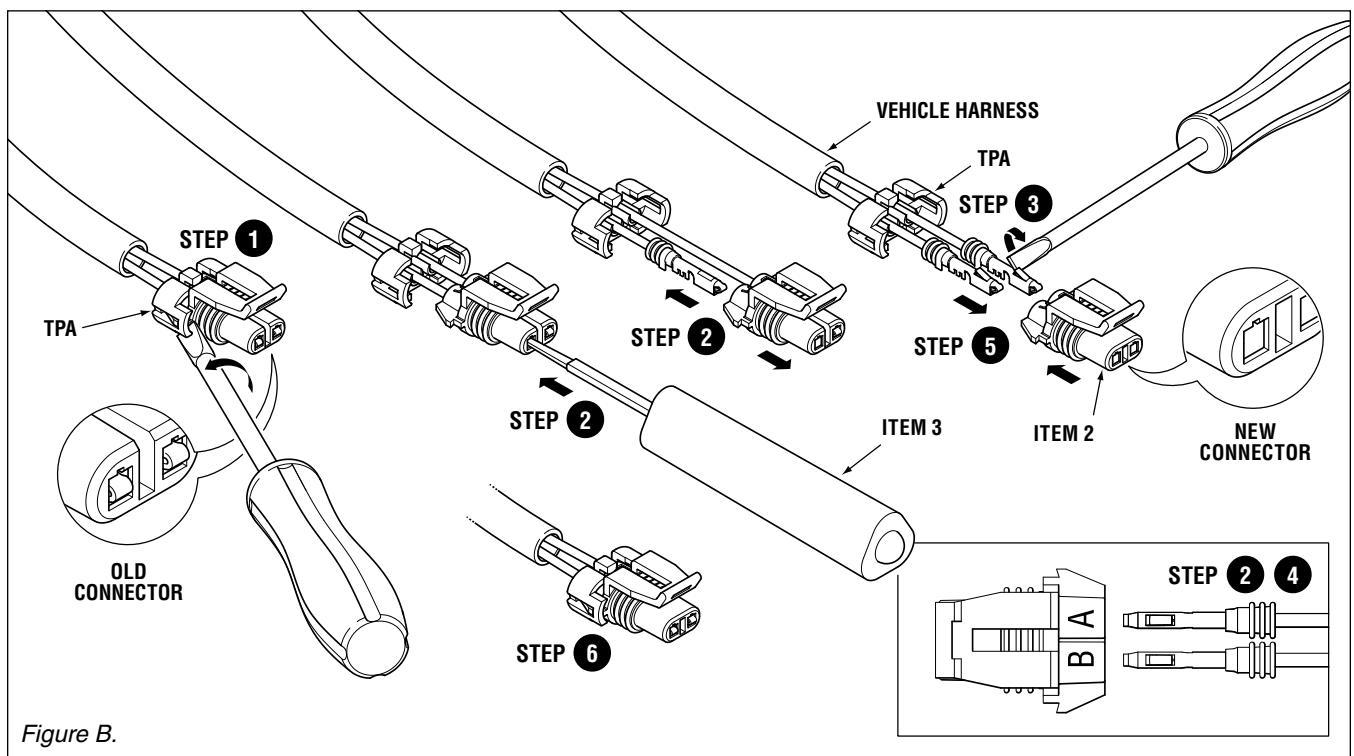

Figure B.